

Datamars Group

Animal Health Delivery Systems

Product Catalogue

Injectors

Oral drenchers

Topical applicators

Packaging

Specialty items



Brands of Datamars Group

SIMCRO™

njphillips  **com**

A REPUTATION FOR ACCURACY AND USER EXPERIENCE

Over 80 years of heritage serving the animal health delivery systems and speciality packaging industry.

Simcro™ and NJ Phillips™ solutions are built on solid partnerships, genuine innovation and trusted ability to deliver. With a long history in pharmaceutical delivery our focus is on the future.

In recent times, pharmacological breakthroughs have become increasingly complex. They demand greater accuracy in the delivery device and ground-breaking protective and easy-to-use packaging and dispensing equipment.

The Simcro and NJ Phillips brands have proven capability in research, development and manufacturing of the world's most innovative delivery technologies.

We also know there's more to consider than simply delivering an unfailingly accurate dose. A focus on animal welfare, operator safety, treatment efficacy and user experience are the hallmarks of our products.





GUARDED INJECTORS	1
TUBE FED INJECTORS	4
FORWARD SELECTABLE INJECTORS	6
BOTTLE MOUNT INJECTORS	7
REPEATER INJECTORS	9
ORAL DRENCHERS	10
TOPICAL APPLICATORS	12
ORAL BOLUS APPLICATORS	13
POWERED	15
INTRANASAL	16
PACKAGING	17
SPECIALTY ITEMS	21
DEVELOPMENT	22

Sekurus™ Guarded Injector



The Sekurus range of guarded injectors are the result of an exhaustive development process spanning several years that included extensive field trials in several countries. Patented technologies include a two-stage activation mechanism and a self-tenting needle guard.

PATENTED TWO-STAGE SAFETY MECHANISM

The patented two-stage mechanism is specifically designed for accurate penetration and consistent dose placement, either deep subcutaneous or intramuscular.

PATENTED NEEDLE GUARD

The protective needle guard minimises the risk of needle stick related injuries and allows the operator to delay the needle penetration until any animal movement has ceased.

ONE-HANDED SUBCUTANEOUS INJECTION

Administering a one-handed subcutaneous injection is far easier and less hazardous for the operator than two-handed techniques, particularly in confined spaces such as a cattle chute. Sekurus was developed to ensure accurate single-handed subcutaneous or intramuscular drug placement. This allows the user to maintain a safer distance from the animal.

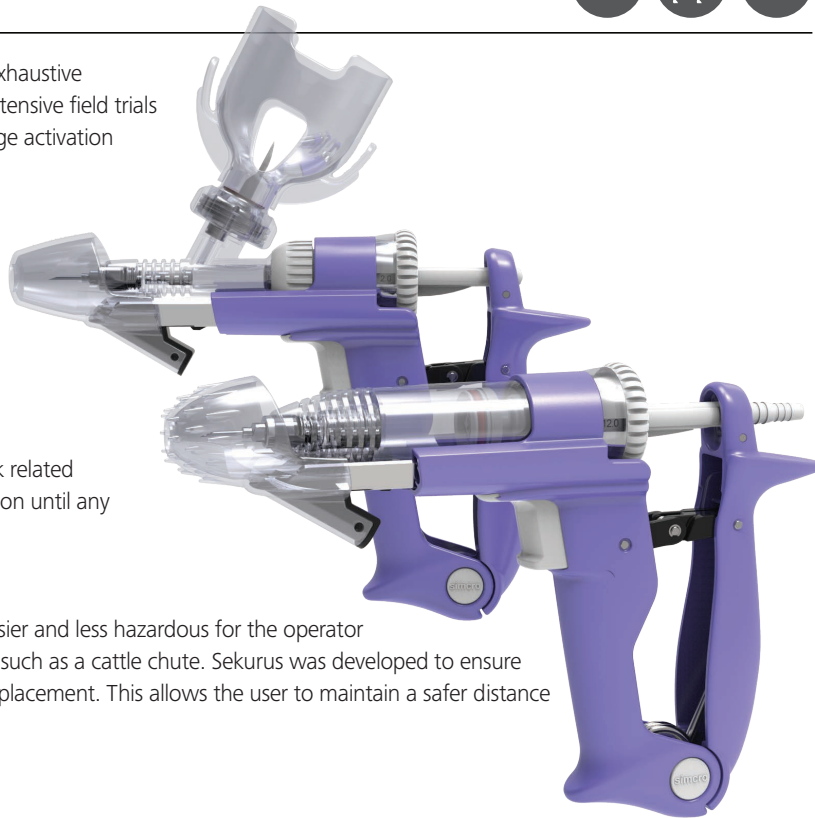

TYPE	MAXIMUM DOSE (mL)	DOSE CONTROL OPTION	DOSE RANGE (mL)	DOSE INCREMENT (mL)
Sekurus Tube Fed	1	Fixed	1	1
	2	Selectable	0.1 - 2	0.1
	2	Fixed	2	2
	2	Selectable	0.5 - 2	0.5
	5	Selectable	0.5 - 5	0.5
	12	Selectable	2.5 - 12	0.5
Sekurus Bottle Mount	1	Fixed	1	1
	1	Selectable	0.1 - 1	0.1
	2	Selectable	1 - 2	1
	2	Fixed	2	2
	2	Selectable	0.5 - 2	0.5
	5	Fixed	5	5
	6	Selectable	0.5 - 6	0.5
	6	Fixed	6	6

Subcutaneous & Intramuscular Guarded Injection

SUBCUTANEOUS INJECTION

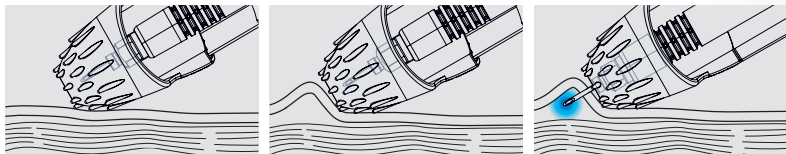

Spiked needle guard grips and tents the animal's skin.
Dose is not administered until full needle penetration achieved.
Dose is delivered at the correct subcutaneous depth.

INTRAMUSCULAR INJECTION

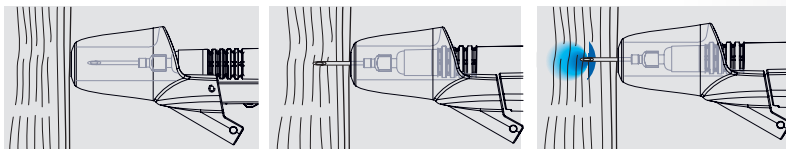

Needle remains protected until the trigger is activated as in the Sekurus or the animal is injected as in the case of the Accurus.
Dose is not administered until full needle penetration achieved.
Dose is delivered at the desired needle penetration.

Accurus Guarded Injector



ONE-HANDED SUBCUTANEOUS INJECTION

Administering a one-handed subcutaneous injection is far easier and less hazardous for the operator than two-handed techniques, particularly in confined spaces such as a cattle chute.

Accurus was developed to ensure accurate single-handed subcutaneous drug placement. This allows the user to maintain a safer distance from the animal.

PATENTED NEEDLE GUARD

The protective needle guard minimises the risk of needle stick related injuries. The needle guard allows the operator to delay the needle penetration until any animal movement has ceased.



New 5mL Accurus Forward Selectable Injector uses a positive stroke that displaces the entire contents of the barrel at any dose setting. This creates a positive feel for users and ensures each dose is administered in full to maximise accuracy and efficacy.

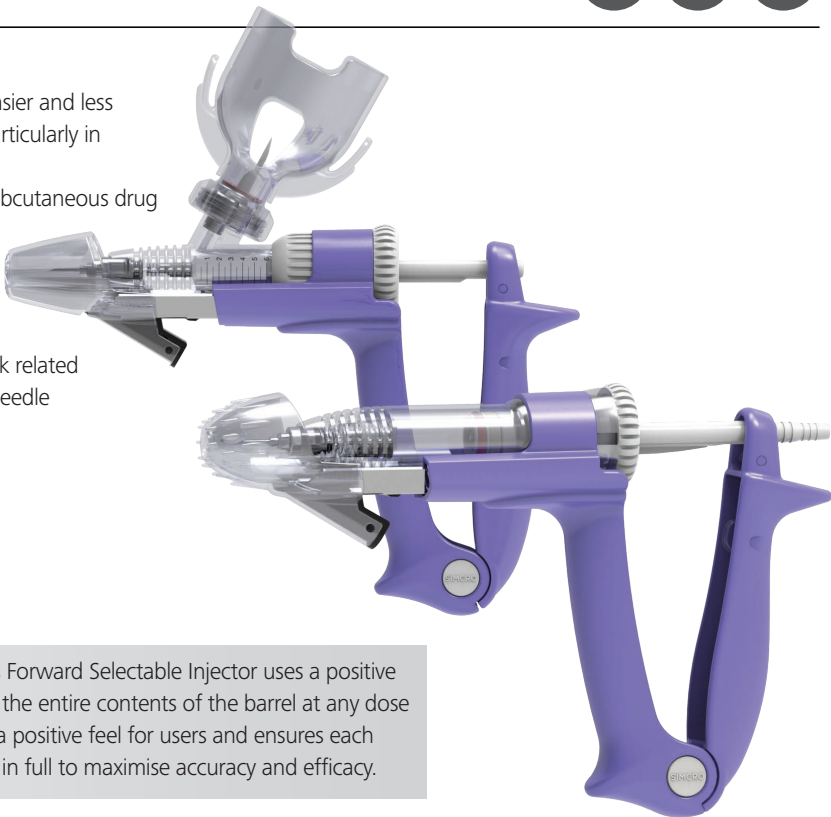

TYPE	MAXIMUM DOSE (mL)	DOSE CONTROL OPTION	DOSE RANGE (mL)	DOSE INCREMENT (mL)
Accurus Tube Fed	0.5	Fixed	0.5	0.5
	1	Fixed	1	1
	2	Selectable	0.5 - 2	0.5
	5	Forward Selectable	0.5 - 5	0.5
	5	Variable	0.5 - 5	0.5
	5	Selectable	0.5 - 5	0.5
	10	Selectable	0.5 - 10	0.5
	12	Selectable	2.5 - 12	0.5
Accurus Bottle Mount	2	Selectable	1 - 2	1
	2	Fixed	2	2
	5	Variable	1 - 5	1
	6	Variable	1 - 6	1
	6	Selectable	0.5 - 6	0.5

Dosage Control Options

SELECTABLE

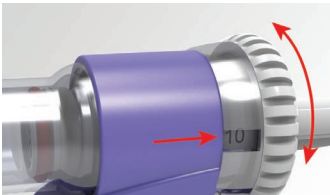

Non-slip selectors allow easy, accurate dose choice, without product loss when changing the dose setting. The indicator window clearly displays the volume.

VARIABLE

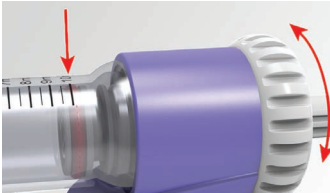

Variable dose selection can be fine tuned against the dose indication markings on the barrel. The dose adjuster is simple to use and allows for infinite dose adjustment.

Slimline Dual Guarded Injector



IMPROVED VACCINATION PRODUCTIVITY

Improve productivity by allowing a farmer to administer multiple compatible products simultaneously, eliminating the need to use two delivery devices, a second operator, or double handling the animals.

OPERATOR SAFETY

With personnel safety receiving more focus on-farm, the Slimline’s needle guard reduces the risk of accidental needle stick injuries.

INDEPENDENT DOSE ADJUSTMENT

Independent dose control allows each chamber to be individually set (and locked) to the desired dose setting. The dual injector can also be set to administer a single vaccine, by setting one chamber to 0 mL.

FRONT HANDLE ACTUATION

Provides the operator with improved controllability and dexterity when administering the treatment.

INDEPENDENT PRIMING

Minimise product wastage when connecting new pharmaceutical product containers to the injector. Priming levers allow each chamber to be primed independently.

EASY SERVICING

Easy removal of rear cover gains access to the fluid valves and o-rings for cleaning and lubricating.

COMPACT, ERGONOMIC PROFILE

Comfortable handset suitable for use with a range of hand sizes.

IMPROVED ANIMAL WELFARE

Reduces the number of needle penetrations, thereby reducing stress and the risk of potential injection site reaction. Soft touch of needle guard allows the operator to delay the needle penetration until any subsequent animal movement has ceased.

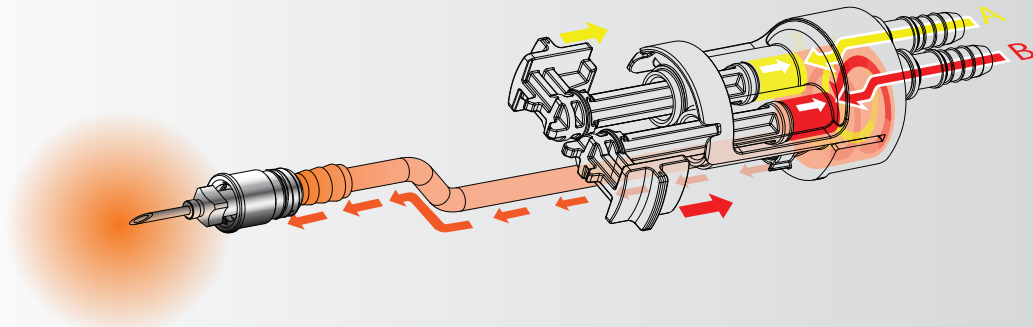

Two compatible formulations are mixed in the injection chamber then administered through a single guarded needle.

TYPE	MAXIMUM DOSE (mL)	DOSE CONTROL OPTION	DOSE RANGE (mL)	DOSE INCREMENT (mL)
Slimline Dual Tube Fed	1	Selectable	0 - 1	0.5
	2	Selectable	0 - 2	1

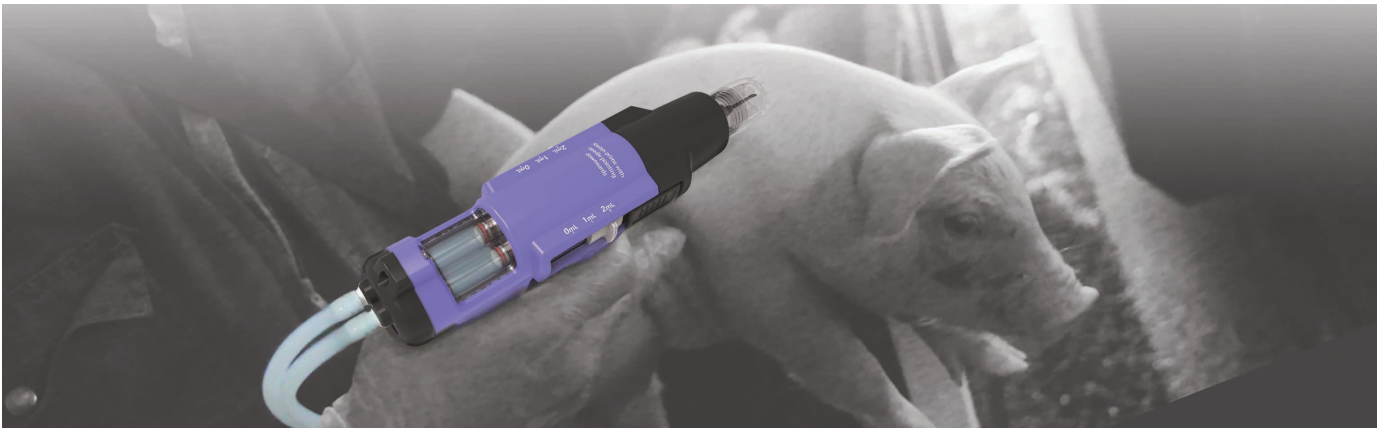

The Slimline family has a patent application granted in the United States with further international patents pending.

Premium Tube Fed Injector



QUICK SET DOSE SELECTOR

Simple, precise dose selection with easy grip volume control.

FEED TUBE CONNECTIONS

The tube connection will accomodate both 4.7 mm and 6.4 mm feed tubes.

ERGONOMIC HANDLE

The handle is designed for operator comfort with a textured non-slip finish.

METAL LUER LOCK (MLL)

Designed for strength whilst allowing a fast and easy needle change. The MLL needle mount will accomodate stainless, alloy and plastic hub needles.

PLASTIC LUER TIP (PLT)

Secures all needle types with a retaining nut. The threaded barrel is also compatible with the Sterimatic™ needle protector and cleaning system.



12 ML PREMIUM HI-VISCOSITY INJECTOR

The Hi-Viscosity injector is designed to accurately administer problematic, viscous formulations even at very cold temperatures.

TYPE	MAXIMUM DOSE (mL)	DOSE CONTROL OPTION	DOSE RANGE (mL)	DOSE INCREMENT (mL)	NEEDLE CONNECTION
Premium Tube Fed	1	Fixed	1	1	MLL
	1	Selectable	0.1 - 1	0.1	MLL
	2	Selectable	0.3 - 2	0.1	MLL, PLT
	2	Fixed	2	2	MLL, PLT
	2	Selectable	1 - 2	1	MLL, PLT
	2	Variable	0.2 - 2	0.2	MLL, PLT
	5	Selectable	0.5 - 5	0.5	MLL, PLT
	5	Variable	1 - 5	0.5	MLL, PLT
	5	Fixed	5	5	MLL, PLT
	10	Selectable	0.5 - 10	0.5	MLL, PLT
	10	Variable	1 - 10	1	MLL, PLT
	12	Selectable	2.5 - 12	0.5	MLL
	15	Selectable	5.5 - 15	0.5	MLL
	15	Variable	2 - 15	1	MLL

Dosage Control Options

SELECTABLE

Non-slip selectors allow easy, accurate dose choice, without product loss when changing the dose setting. The indicator window clearly displays the volume.

VARIABLE

Variable dose selection can be fine tuned against the dose indication markings on the barrel. The dose adjuster is simple to use and allows for infinite dose adjustment.

Optimiser™ Tube Fed Injector

- Accurately delivers all dose volumes with easy-to-use selector.
- Designed for operator comfort, the Optimiser is proven in reliability and durability.
- Also available with oral drencher and pour-on nozzles.



TYPE	MAXIMUM DOSE (mL)	DOSE CONTROL OPTION	DOSE RANGE (mL)	DOSE INCREMENT (mL)
Optimiser Tube Fed	2	Selectable	0.2 - 2	0.2
	5	Selectable	0.5 - 5	0.5
	12.5	Selectable	1 - 12.5	0.5
	15	Selectable	1 - 15	1 - 10 mL: 0.5 mL 10 - 15 mL: 1 mL

Metal Automatic Tube Fed Injector

- Highly durable, made with high quality materials.
- Ergonomic finger grip design supports use over long periods and reduces hand fatigue.
- The tube connection will accommodate 4.8 mm feed tubes.

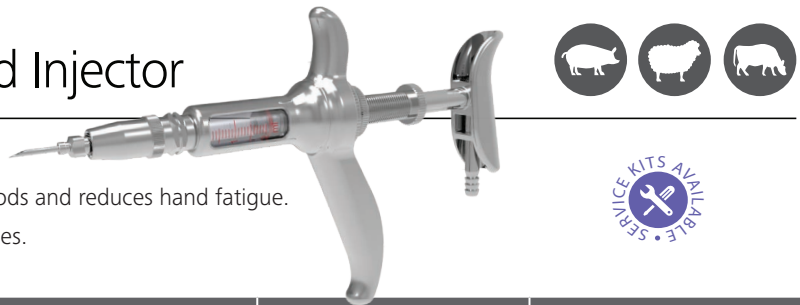

TYPE	MAXIMUM DOSE (mL)	DOSE CONTROL OPTION	DOSE RANGE (mL)	DOSE INCREMENT (mL)
Metal Automatic Tube Fed	1	Variable	0.1 - 1	0.1
	2	Variable	0.5 - 2	0.5
	5	Variable	0.5 - 5	0.5

Compact Tube Fed Injector

- Proven, reliable and durable work horse.
- Flexible variable dose selection.
- 10mL Compact injectors are available with oral drencher and pour-on nozzles.

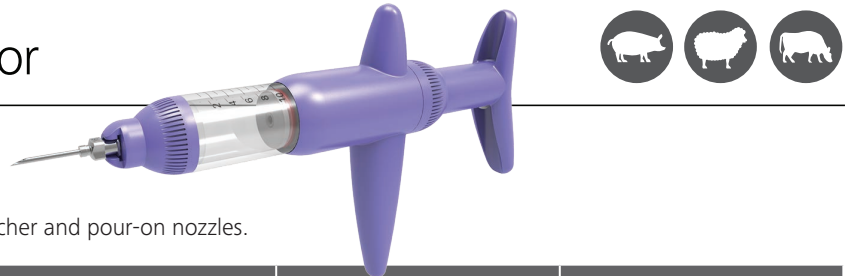

TYPE	MAXIMUM DOSE (mL)	DOSE CONTROL OPTION	DOSE RANGE (mL)	DOSE INCREMENT (mL)
Compact Tube Fed	1	Variable	0.1 - 1	0.1
	2	Variable	0.2 - 2	0.2
	5	Variable	0.5 - 5	0.5
	10	Variable	1 - 10	1

Handy Tube Fed Injector

- Lightweight, accurate and easy to use.
- Superior comfort grip and easy-off needle nut.



TYPE	MAXIMUM DOSE (mL)	DOSE CONTROL OPTION	DOSE RANGE (mL)	DOSE INCREMENT (mL)
Handy Tube Fed	1	Variable	0.1 - 1	0.1
	1	Variable	0.1 - 1	0.1
	3	Variable	0.25 - 3	0.25
	5	Variable	0.25 - 5	0.25
	10	Variable	0.5 - 10	0.5

Forward Selectable Tube Fed & Bottle Mount



For an animal health treatment to be effective it needs to be delivered at the correct dose. The Simcro Forward Selectable Injector range gives the user simple and reliable dose accuracy even at low dose volumes, ensuring confidence and efficacy at all dose settings.

REDUCED FATIGUE

The ergonomic design, partnered with a reduced hand span, provides a comfortable grip, tactile feedback and reduced fatigue over extended periods of use.

SELECTABLE DOSE

The injector's improved valve configuration ensures accurate priming and dose administration at any chosen dose selection.

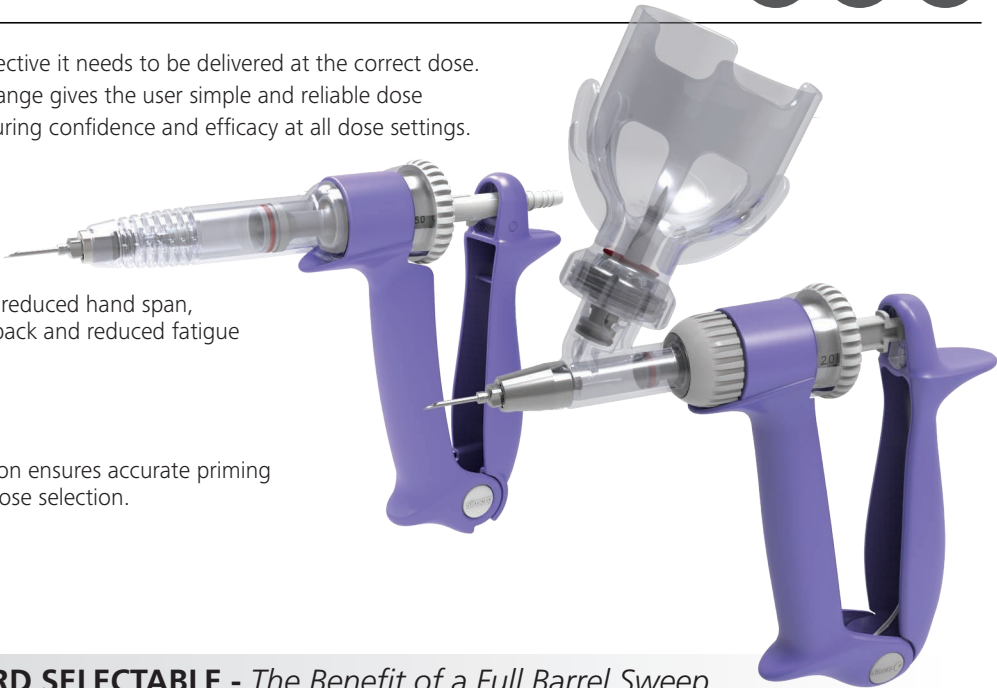

FORWARD SELECTABLE - *The Benefit of a Full Barrel Sweep*

In addition to the other Forward Selectable Injector features, the Forward Selectable Injector uses a positive stroke, that displaces the entire contents of the barrel at any dose setting. This creates a positive feel for users and ensures each dose is administered in full to ensure dose accuracy and maximum drug efficacy.



The key to efficacy is precision. At low doses, the plunger of a Reverse Selectable Injector is still acting on a full barrel of product. This makes air in the system difficult to purge, as air bubbles compress rather than get expelled out of the barrel. If these bubbles go unnoticed they can lead to multiple under doses being administered. The injector's Forward Selectable configuration reduces the chance of bubbles in the system and makes them easy to remove, ensuring dose accuracy and efficacy of the treatment.

TYPE	MAXIMUM DOSE (mL)	DOSE CONTROL OPTION	DOSE RANGE (mL)	DOSE INCREMENT (mL)
Forward Selectable Tube Fed	5	Forward Selectable	0.5 - 5	0.5
	12	Forward Selectable	2.5 - 12	0.5

TYPE	MAXIMUM DOSE (mL)	DOSE CONTROL OPTION	DOSE RANGE (mL)	DOSE INCREMENT (mL)
Forward Selectable Bottle Mount	0.5	Forward Selectable	0.05 - 0.5	0.05
	0.5	Fixed	0.5	0.5
	1	Fixed	1	1
	2	Forward Selectable	0.1 - 2	0.1
	2	Fixed	2	2
	2	Forward Selectable	0.5 - 2	0.5

Premium Bottle Mount Injector



ADJUSTABLE BARREL

Fully adjustable barrel orientation allows the bottle angle to be adjusted for all operator dosing styles, particularly in confined spaces.

QUICK SET DOSE SELECTOR

Precise, easy grip volume control.

ERGONOMIC HANDLE

Handle designed for operator comfort with textured non-slip finish.

METAL LUER LOCK (MLL)

Designed for strength whilst allowing a fast and easy needle change. The MLL needle mount will accomodate stainless, alloy and plastic hub needles.

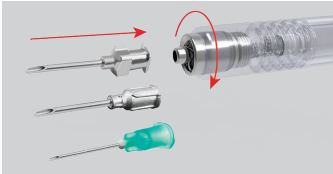

PLASTIC LUER TIP (PLT)

Secures all needle types with a retaining nut. The threaded barrel is also compatible with the Sterimatic™ needle protector and cleaning system.

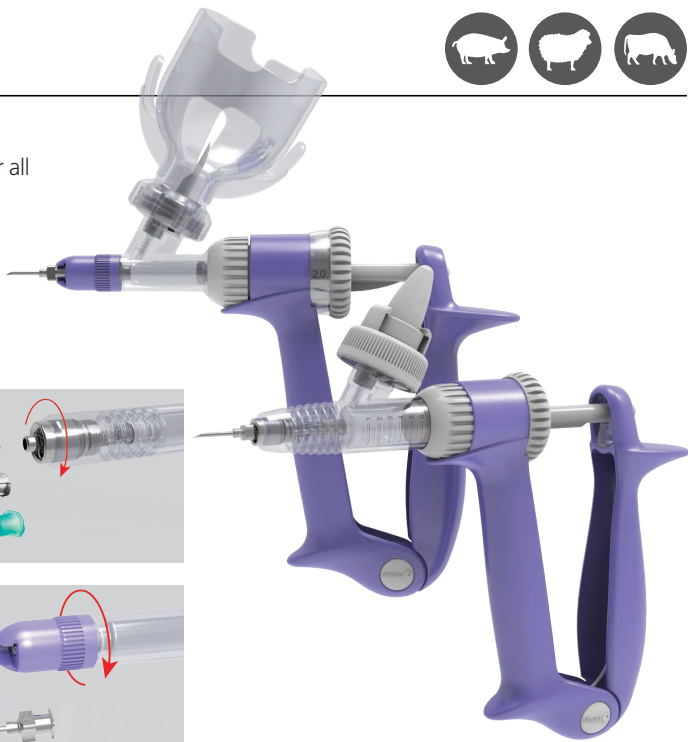
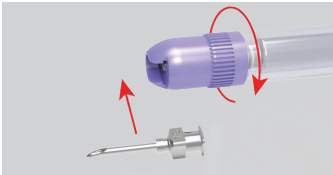

AVAILABLE IN FOUR BOTTLE MOUNT OPTIONS

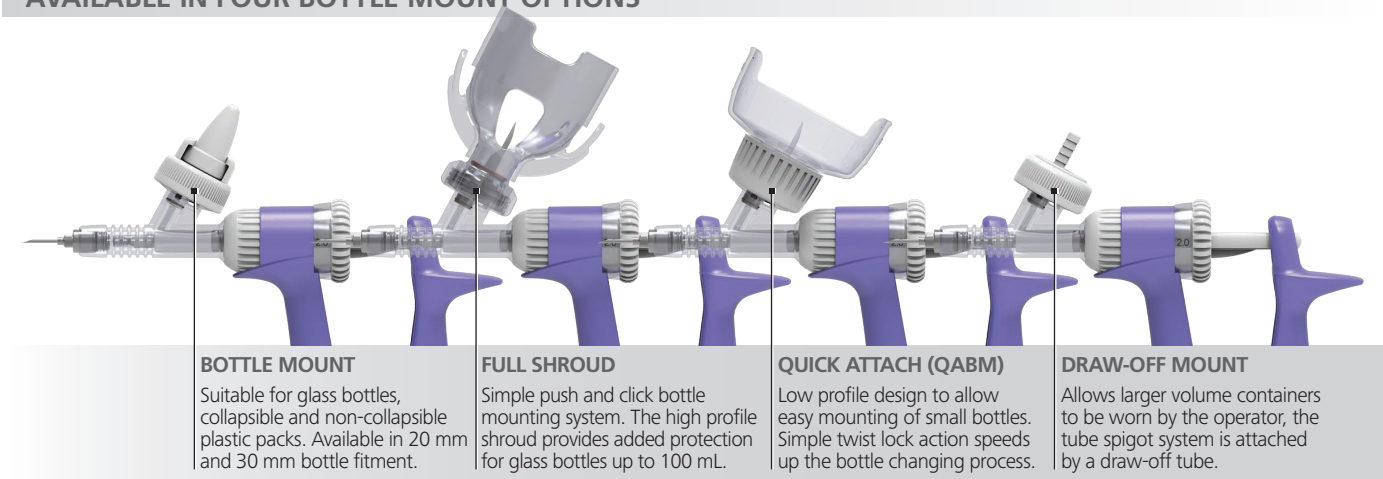

ADJUSTABLE BARREL POSITION

The Premium Bottle Mount Injector barrel can be rotated before use by loosening the Barrel Band. This allows the Barrel to be locked into a different position that may be more comfortable and convenient for the user.



PREMIUM BOTTLE ADAPTER SIZE OPTIONS

Simcro has a range of bottle adapters (20 mm & 30 mm) and pillow pack adapters.

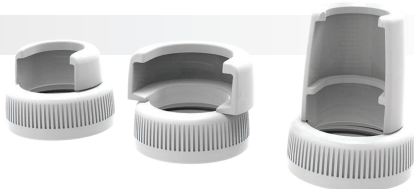

TYPE	MAXIMUM DOSE (mL)	DOSE CONTROL OPTION	DOSE RANGE (mL)	DOSE INCREMENT (mL)	NEEDLE CONNECTION
Premium Bottle Mount	1	Selectable	0.1 - 1	0.1	MLL
	2	Fixed	2	2	MLL, PLT
	2	Selectable	0.2 - 2	0.2	MLL, PLT
	2	Variable	0.2 - 2	0.2	PLT
	6	Selectable	0.5 - 6	0.5	MLL
	6	Variable	0.5 - 6	0.5	MLL

Ultimate BMV™ Bottle Mount Injector

- Accurately delivers all dose volumes with an easy-to-use selector.
- Textured handset for greater grip.
- Forward Selectable dose control uses a positive stroke which displaces the entire contents of the barrel at any dose setting, ensuring dose accuracy and efficacy of the treatment.
- 20 mm, 30 mm and 33 mm bottle adapters and bottle shrouds are available separately.

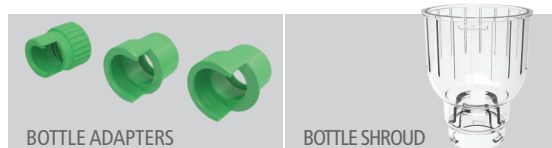

TYPE	MAXIMUM DOSE (mL)	DOSE CONTROL OPTION	DOSE RANGE (mL)	DOSE INCREMENT (mL)
Ultimate BMV Bottle Mount Injector	0.3	Forward Selectable	0.1 - 0.3	0.05
	0.5	Forward Selectable	0.05 - 0.5	0.05
	2	Forward Selectable	0.2 - 2.0	0.2
	6	Forward Selectable	0.5 - 6.0	0.5
	10	Forward Selectable	0.5 - 10	0.5

Metal Automatic Bottle Mount Injector

- Full bottle shroud provides greater stability to product bottle.
- Highly durable made with high quality materials.
- Variable dose adjustment allows easy, flexible dose.
- Ergonomic finger grip design supports use over long periods and reduces hand fatigue.

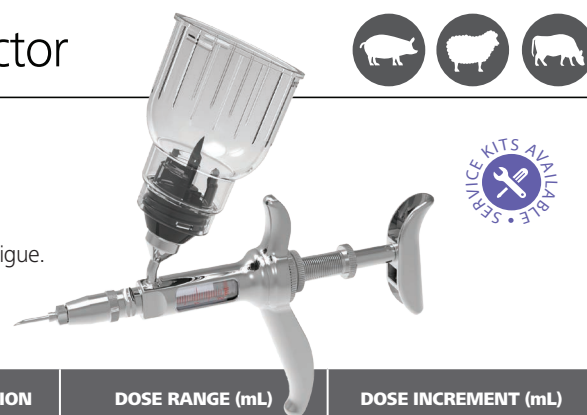

TYPE	MAXIMUM DOSE (mL)	DOSE CONTROL OPTION	DOSE RANGE (mL)	DOSE INCREMENT (mL)
Metal Automatic Bottle Mount	1	Variable	0.1 - 1	0.1
	2	Variable	0.1 - 2	0.1
	5	Variable	0.5 - 5	0.5

Compact Bottle Mount Injector

- Proven, reliable and durable work horse.
- Flexible variable dose selection.

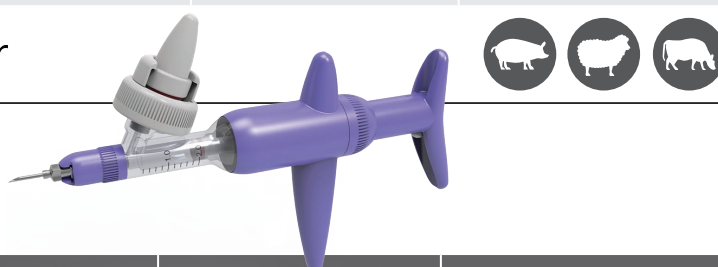

TYPE	MAXIMUM DOSE (mL)	DOSE CONTROL OPTION	DOSE RANGE (mL)	DOSE INCREMENT (mL)
Compact Bottle Mount	2	Variable	0.2 - 2	0.2
	5	Variable	0.5 - 5	0.5

Optimiser™ Bottle Mount Injector

- Designed for operator comfort, the Optimiser is proven in reliability and durability.
- Accurately delivers up to 12.5 mL with an easy to use selector.
- 20 mm, 30 mm and 33 mm bottle adapters and bottle shrouds are available separately.

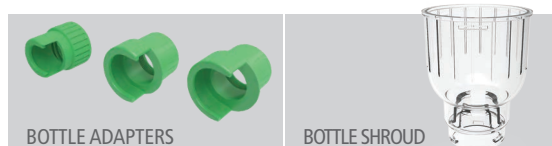

TYPE	MAXIMUM DOSE (mL)	DOSE CONTROL OPTION	DOSE RANGE (mL)	DOSE INCREMENT (mL)
Optimiser Bottle Mount	12.5	Selectable	1 - 12.5	0.5

Ezi-Grip Repeater



- Highly durable made with high quality materials.
- Fixed dose settings for accurate delivery.
- Easy to clean and maintain.
- Ergonomic and robust metal handle supports use over long periods and reduces hand fatigue.



BARREL SIZE	DOSE RANGE (mL)	DOSE INCREMENT (mL)	DOSE TYPE	BARREL
25 mL	0.5 - 2.5	0.5	Selectable	Polysulfone
50 mL	1 - 5	1	Selectable	Polysulfone
25 mL	0.5 - 2.5	0.5	Selectable	Polypropylene
50 mL	1 - 5	1	Selectable	Polypropylene

Pistol Grip Repeater



- Fixed dose settings for accurate delivery.
- Built-in needle magazine saves you time.
- Ergonomic pistol grip design reduces hand strain.
- Optional polypropylene barrel for increased chemical resistance.
- Easy to clean and maintain.



BARREL SIZE	DOSE RANGE (mL)	DOSE INCREMENT (mL)	DOSE TYPE	BARREL
25 mL	0.5 - 2.5	0.5	Selectable	Polysulfone
50 mL	1 - 5	1	Selectable	Polysulfone
25 mL	0.5 - 2.5	0.5	Selectable	Polypropylene
50 mL	1 - 5	1	Selectable	Polypropylene



Customisation

The Simcro and NJ Phillips brands specialise in customised animal health delivery systems to represent and partner with our client's brand and products. The use of custom colour options provides an enhanced presentation to the end user and gives an instantly recognisable brand platform.



Simcro™ Drencher



The Oral Drencher Range has been designed for use with a vast range of oral anthelmintics. The development has focussed on operator comfort, ease of administration, accuracy and durability.

- Non-drip nozzle eliminates post delivery spurt and product wastage.
- Ergonomic design partnered with a reduced hand span provides comfortable grip and tactile feedback.
- The tube connection will accommodate both 6.4 mm or 9.5 mm feed tubes.
- Durable non-corrosive stainless steel drenching nozzles.
- Floating Hook Drencher is designed with easier oral drenching of cattle in mind, the floating hook allows the operator to remain at a safe distance from the animal when drenching.

AVAILABLE IN 6 ORAL DRENCH NOZZLE OPTIONS

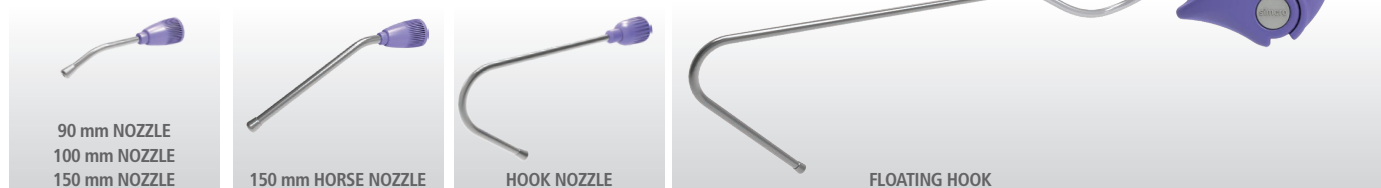

DOSE CONTROL OPTIONS			NOZZLE OPTIONS					
MAXIMUM DOSE	VARIABLE	SELECTABLE	90 mm NOZZLE	100 mm NOZZLE	150 mm NOZZLE	HOOK NOZZLE	HORSE 150 mm	FLOATING HOOK
15 mL	■		■	■	■	■	■	■
18 mL	■		■	■	■	■	■	■
20 mL	■		■	■	■	■	■	■
30 mL	■	■	■	■	■	■	■	■
65 mL		■	■	■	■	■	■	■
75 mL		■			■	■		■

8 mL Metal Lamb Drencher

- Highly durable robust metal construction.
- Variable dose adjustment allows easy, flexible dose.
- Small 'thick' nozzle to safely use with lambs.
- Ergonomic design with handle tension adjuster provides comfortable grip, tactile feedback and reduced fatigue over extended time periods.



TYPE	MAXIMUM DOSE (mL)	DOSE RANGE (mL)	DOSE INCREMENT (mL)
Metal Lamb Drencher	8	0.5 - 8	0.5

20 mL Metal Drencher / Injector



Popular injector and drencher kit for cattle and sheep farmers.

- High quality metal drencher with optional injector attachment.
- Highly chemical resistant cylinder with moulded graduations.
- Variable easy-to-use dose adjustment.
- High-flow, blockage resistant valves.
- Highly chemical resistant cylinder with moulded graduations.



Optional components include: 4" lamb nozzle, 4" sheep nozzle, 6" cattle nozzle, injector attachment and delivery tube.

TYPE	MAXIMUM DOSE (mL)	DOSE RANGE (mL)	DOSE INCREMENT (mL)
Metal Drencher / Injector	20	1 - 20	1

Low Dose Oral Drencher



- Simple, precise dose selection with easy grip volume control.
- The tube connection will accomodate both 4.7 mm and 6.4 mm feed tubes.
- The ergonomic handle is designed for operator comfort with a textured non-slip finish.



MAXIMUM DOSE	VARIABLE	FIXED	SELECTABLE
2 mL		■	
5 mL	■	■	■
10 mL	■		■
15 mL	■		



60 mm NOZZLE

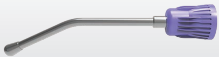

95 mm NOZZLE

Low Dose Bottle Mount Drencher



- Three bottle mount options available in a Full Shroud, Bottle Mount and Draw-off Mount.
- Precise, easy grip volume dose control.

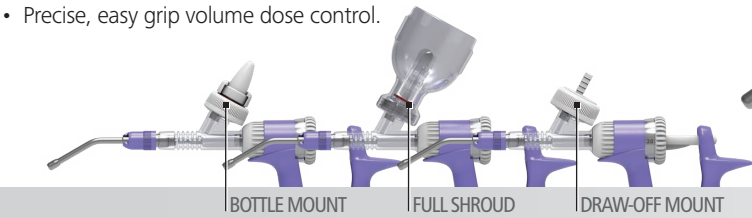

TYPE	MAXIMUM DOSE	VARIABLE	FIXED	SELECTABLE
Low Dose Bottle Mount Drencher	1mL			■
	2mL	■	■	■
	6mL	■		■



60 mm NOZZLE



95 mm NOZZLE

Ultimate BMV™ Drencher



- Angled nozzles with better visibility upon application.
- Handle designed with textured handset non-slip finish for greater grip.
- Proven, reliable and durable design.
- Available in a straight and metal drench nozzle.



TYPE	MAXIMUM DOSE (mL)	DOSE RANGE (mL)	DOSE INCREMENT (mL)
Ultimate BMV Drencher	0.5	0.05 - 0.5	0.05
	2	0.2 - 2	0.2
	6	0.5 - 6	0.5

150 mL Non-Automatic Drencher



- Robust construction designed for use with small herds.
- Fills through nozzle with variable dose setting.



TYPE	MAXIMUM DOSE (mL)	DOSE RANGE (mL)	DOSE INCREMENT (mL)
Non-Automatic Drencher	150	25 - 150	25

BREAZE™ Topical and Oral Applicator



“Shoot the Breaze, feel the difference”

High flow outlet valve and patented Breaze technology:

- Prevents post-delivery spurt.
- Reduces operator hand force providing a smooth and easy squeeze ensuring a strong, reliable refill for both topical and oral application.



AVAILABLE IN 8 NOZZLE OPTIONS



MAXIMUM DOSE	VARIABLE	SELECTABLE	KINKED ROSE NOZZLE	T-BAR NOZZLE	FAN-SPRAY NOZZLE	ORAL NOZZLE	HOOK NOZZLE	FLOATING HOOK NOZZLE
30 mL	■	■	■	■	■	■		■
65 mL	■	■	■		■	■	■	■
80 mL		■	■		■	■	■	■

The Breaze applicator family has a patent application granted in New Zealand and Australia with further international patents pending.

Magnum Topical and Oral Applicator



- Accurate, smooth actioned administration of pour-on and oral product.
- Angled nozzles for better visibility upon application.
- Simple, precise dose selection with easy grip volume control.
- Quick refill with SoftLock valve technology, reducing post-delivery spurt.
- Easy to squeeze handle set reducing operator fatigue.
- Easy barrel removal system for cleaning and relubrication.



AVAILABLE IN 7 NOZZLE OPTIONS

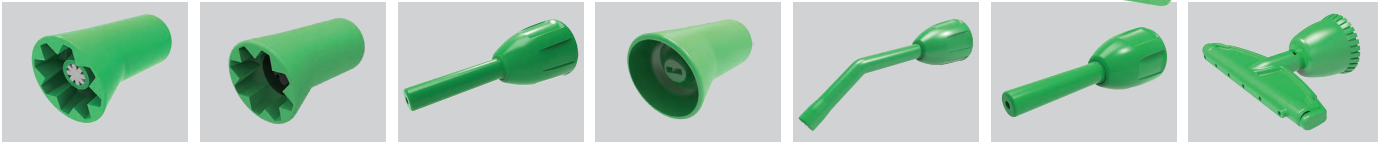

MAXIMUM DOSE	STAR TIP NOZZLE	SHOWER NOZZLE	PIN STRIPE NOZZLE	FAN-SPRAY NOZZLE	KINKED NOZZLE	STRAIGHT NOZZLE	T-BAR NOZZLE
40 mL			■	■	■	■	■
70 mL	■	■		■			
80 mL	■	■		■			

The Magnum applicator family has a patent application granted in New Zealand, Australia, United States and Brazil.

Customisation

The Simcro and NJ Phillips brands specialise in customised animal health delivery systems to represent and partner with our client’s brand and products. The use of custom colour options provides an enhanced presentation to the end user and gives an instantly recognisable brand platform.





Premium Topical Applicator

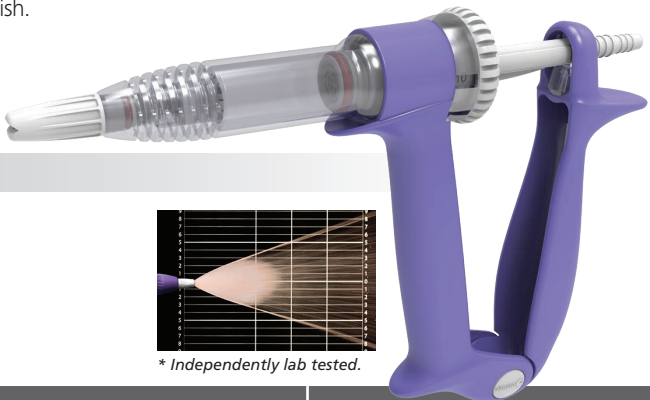

- Ergonomic handle designed for operator comfort with a textured non-slip finish.
- Available in variable, selectable and fixed dose control options.
- The tube connection will accomodate both 4.7 mm and 6.4 mm feed tubes.

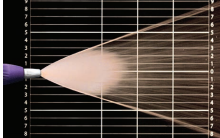

AVAILABLE IN 2 NOZZLE OPTIONS			
			
FAN SPRAY NOZZLE	SINGLE STREAM NOZZLE	* Independently lab tested.	
MAXIMUM DOSE	VARIABLE	FIXED	SELECTABLE
2 mL		■	
5 mL	■	■	■
10 mL	■		■
12 mL			■
15 mL	■		



Simcro™ Topical Applicator



Simcro’s Topical Pour-On Range has been developed to meet the requirements of strength and accuracy in harsh operating environments withstanding the often chemically aggressive nature of the products being administered.

- Simple, precise dose selection with easy grip volume control.
- Ergonomic handle designed for operator comfort with a textured non-slip finish.

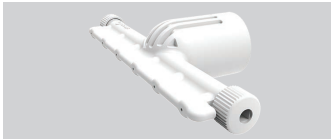

AVAILABLE IN 4 NOZZLE OPTIONS						
						
KINKED ROSE NOZZLE	T-BAR NOZZLE	FAN-SPRAY NOZZLE	SINGLE STREAM NOZZLE			
MAXIMUM DOSE	VARIABLE	SELECTABLE	KINKED ROSE NOZZLE	T-BAR NOZZLE	FAN-SPRAY NOZZLE	SINGLE STREAM NOZZLE
15 mL	■		■	■	■	■
20 mL	■		■	■	■	■
30 mL	■	■	■	■	■	■
65 mL		■	■		■	
75 mL		■	■		■	

Measuring Pourer Cap



The Measuring Pourer Cap series is ideally suited for situations where smaller numbers of animals are being treated. Very quick to set up, the Measuring Pourer Cap provides simplicity, convenience and accuracy.

PATENTED SELF-REGULATING REFILL CAPABILITY



Rotate cap to set dose



Squeeze the container to flood the measure cup



Release the squeeze, excess product will be drawn back



Pour the dose along the back line of the animal



Available in 25 mL and 60 mL options with a range of cap sizes



Hydraulic Oral Bolus

Designed specifically to administer boli to cattle which require a longer stroke to release the product when dosing. The robust hydraulic action of Simcro's bolus applicator allows for larger boli to be administered to cattle with a single-handed trigger action.

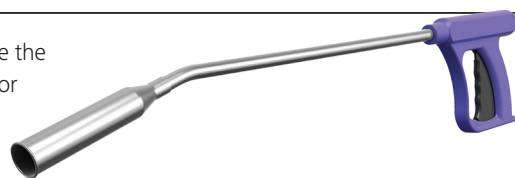

Metal Oral Bolus

A strong, direct action bolus applicator made from a combination of stainless steel and cast alloy components catering for both sheep and cattle.

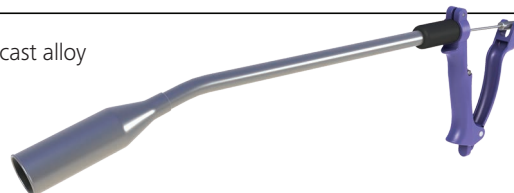

Flexi Oral Bolus

The flexible shafts reduce the risk of an animal injury and make administration easier while moving through stock. The button series has a shorter more direct action.



Dagger Oral Bolus

A light weight option from a high-grade plastic to administer various tablet medications.

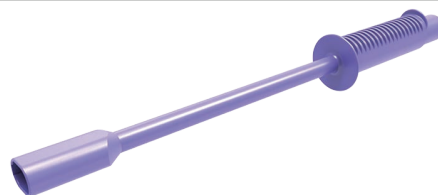

Optimiser™ Oral Bolus

- Suitable for smaller bolus mineral capsules, RFID capsules and vitamin capsules.
- Sturdy metal design with stainless cup and shaft.



Big Gun Oral Bolus

- Suitable for larger bolus mineral capsules, RFID capsules and vitamin capsules.
- Sturdy metal design with stainless cup and shaft.



All-Metal Oral Bolus

- Specifically designed to dispense multiple bolus capsules or large boli with the longer handle stroke.
- Sturdy all-metal design.

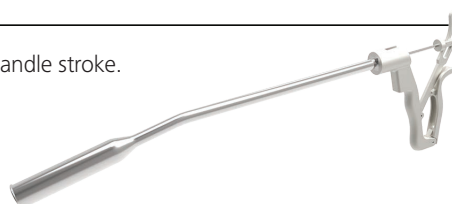

The stroke length, cup size and shaft length can be customised specific to product requirements for all of the Oral Bolus Applicators. Custom colours and branding options are available.

PowerMaster Pneumatic Line

Durable, easy-to-use air powered device for accurate delivery of injectable, topical and oral pharmaceutical applications.



KEY FEATURES:

- Easy cleaning with removable barrel.
- Accurately and consistently administers designated dose with a quick refill action.
- Designed with an ergonomic hand grip to reduce fatigue whilst processing large numbers of animals.

- 1 Connect the feed tube to the PowerMaster device.
- 2 Connect the air supply from the air compressor.
- 3 Prime and then the PowerMaster is ready to use.

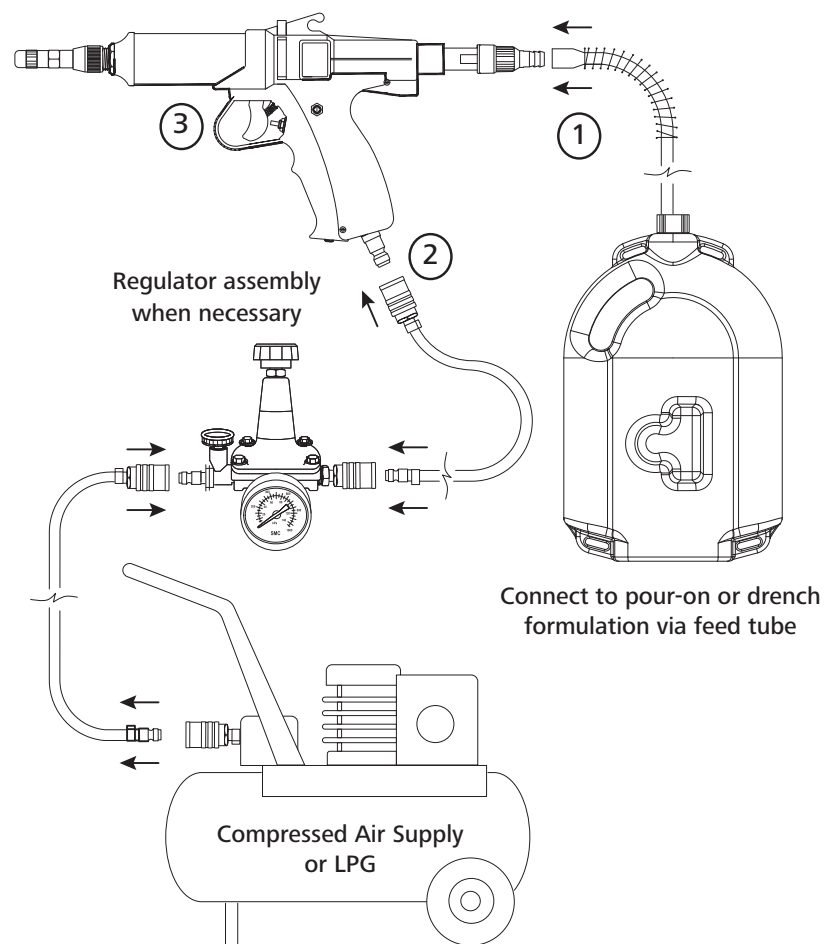

MAXIMUM DOSE	PORTABLE MODEL	DOSE RANGE (mL)	DOSE INCREMENT (mL)
15 mL	Injector	1 - 15	1
50 mL	Drencher	5 - 50	2.5
65 mL	Pour-On	5 - 65	5

Intranasal Applicators

SIMPLE SYSTEM FOR DELIVERY OF UP TO 2 ML OF NASAL DRUG

The Simcro Premium 2 mL Forward Selectable Bottle Mount Applicator which can deliver dose volumes ranging from 0.1 mL to 2 mL in 0.1 mL increments.

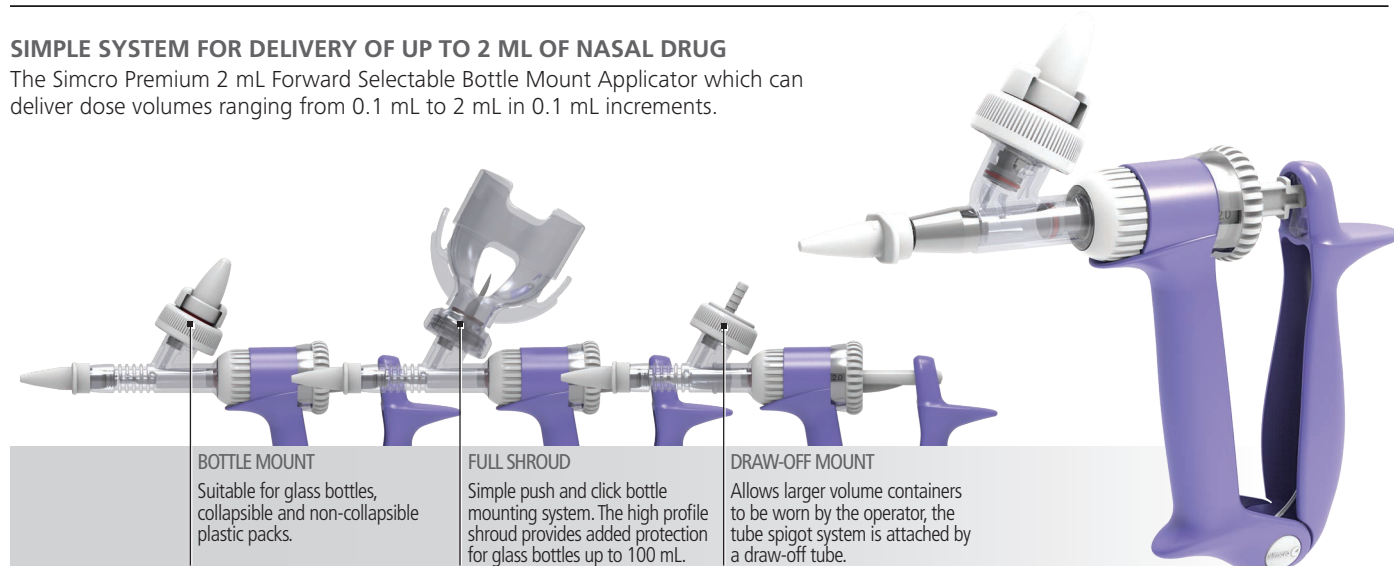

3 intranasal nozzles

Atomising Intranasal Nozzle

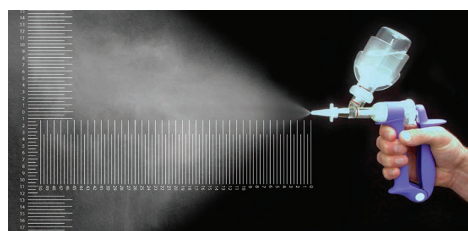

QUICK AND EASY ATTACHMENT

Nozzle simply screws onto the Intranasal Applicator. The Atomising Intranasal Nozzle provides a fine, consistent dispersion, with droplet size of <100 microns (dependent on the formulation). Independently lab tested.



Flexible Atomising Intranasal Nozzle

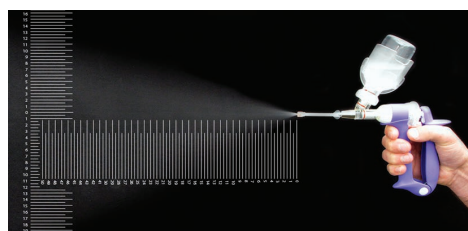

FLEXIBLE, FINE DISPERSION

Sterimatic nozzle simply screws onto the Intranasal Applicator. The Flexible Atomising nozzle is a non-rigid tip which delivers a fine, consistent dispersion of intranasal product.



Single Stream Intranasal Nozzle

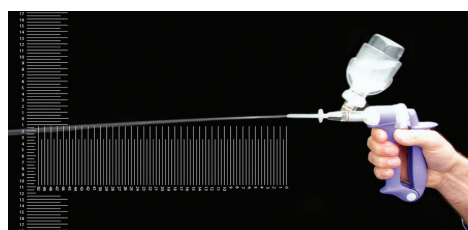

SINGLE STREAM DISPERSION

The Single Stream Nozzle delivers a solid stream of intranasal product deep into the nasal cavity of livestock.

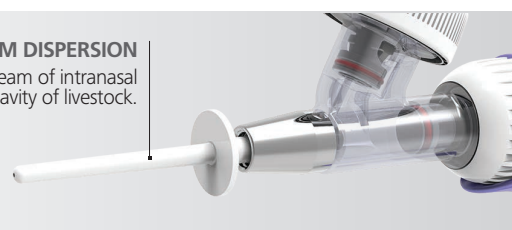

Standard Backpack

- Sizes: 1 L, 2.5 L and 5 L.
- Neck size compatible with 38 mm caps.
- Lugs enable backpack to be worn by user with straps.
- Ergonomic carry handle.
- Backpack can be placed on flat surface to sit upright.
- Pocket available in 2.5 L and 5 L sizes.



Tamper Evident Backpack

- Sizes: 1 L, 2.5 L and 5 L.
- Neck size compatible with 38 mm caps.
- Pocket available in 2.5 L and 5 L sizes.
- Compatible with Tamper Evident closure.



Teardrop Backpack

- Sizes: 2.2 L and 5 L.
- Neck size compatible with 38 mm caps.
- Strap and Dip-Tube Pocket available in 2.5 L and 5 L sizes.
- Compatible with Tamper Evident closure.



Collapsible Backpack

- Size: 5 L.
- Neck size compatible with 38 mm caps.
- Soft and comfortable to wear.
- Easy to see fill level and fill graduations.



Customisation

The Simcro and NJ Phillips brands specialise in customised products to represent and partner with our client's brand and products. The use of custom colour options provides an enhanced presentation to the end user and gives an instantly recognisable brand platform.



Standard Upright Bottle

- Sizes: 250 mL, 500 mL and 1,000 mL.
- Neck size compatible with 28 mm caps.



Tamper Evident Upright Bottle

- Size: 250 mL.
- Neck size compatible with 38 mm caps.
- Compatible with Tamper Evident closure.



Tamper Evident Hanging Bottle

- Sizes: 250 mL and 500 mL.
- Neck size compatible with 38 mm caps.
- Tamper Evident: Yes.



Backpack Bracket

- A convenient system to retain an upright draw-off on the backpack for transit and retail display.
- Available to fit standard and tamper evident 1 L, 2.5 L and 5 L backpacks.

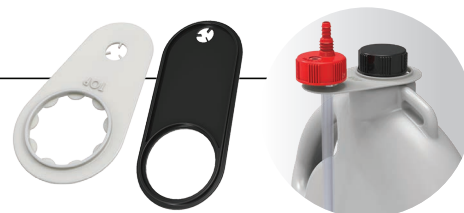

Backpack Strap

- Strong, woven backpack straps come complete with an adjustable slip.
- A single strap makes the backpack ready to wear.
- Available in black and red.



Bottle Cradles

- A convenient hanger to allow bottles to be hung from the neck or a chute.
- Available for 50 mL, 100 mL, 250 mL and 500 mL bottles.

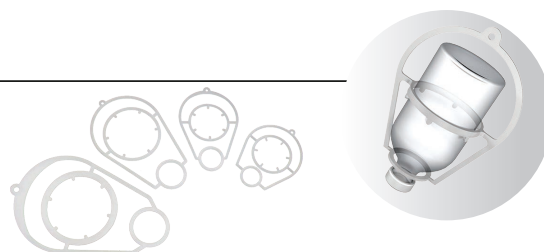

Bottle Protection Sleeves

- Smart, compact and designed to protect bottles from breakage.
- Sizes: 50 mL, 100 mL, 250 mL and 500 mL.



The range of Bottle Protection Sleeves can be customised in a range of colours to suit corporate or branding requirements.

Cone Closure Cap

- Sizes: 28 mm, 32 mm and 38 mm.
- A simple robust cone seal closure cap for use on Simcro backpacks and bottles.



Wadded Closure Cap

- Sizes: 28 mm, 32 mm and 38 mm.
- Compatible with Tamper Evident closure.
- The Wadded Closure Cap can accommodate specific wad materials including polyethylene, foil and induction seal options.



Wadded Tamper Evident Closure Cap

- Size: 38 mm.
- Compatible with Tamper Evident closure.
- With a Tamper Evident locking ring for product security, this 38 mm cap also accommodates all types of wadding options.



Non-Vented Dual Spigot Dispensing Cap

- Size: 28 mm.
- Compatible with 6.4 mm and 9.5 mm feed tube.
- Non-vented.
- Compatible with inverted backpacks only.
- Available in white only.



Dome Spigot Dispensing Cap

- Size: 38 mm.
- Compatible with 6.4 mm and 9.5 mm feed tube.
- Vented.
- Compatible with upright and inverted dispensing backpacks.



Vented Dual Spigot Dispensing Cap

- Sizes: 28 mm, 32 mm, 38 mm and 46 mm, available in select colours.
- Compatible with 6.4 mm and 9.5 mm feed tube.
- Vented.
- 32 mm and 38 mm compatible with upright and inverted dispensing backpacks.
- 28 mm and 46 mm compatible with inverted dispensing backpacks only.



Tethered Vented Dual Spigot Dispensing Cap

- Sizes: 32 mm and 46 mm.
- Compatible with 6.4 mm and 9.5 mm feed tube.
- Vented.
- 32 mm compatible with upright and inverted dispensing backpacks.
- 46 mm compatible with inverted dispensing backpacks only.

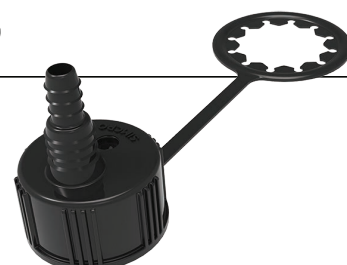

Clip-On Non-Vented Draw-Off

- Size: 20 mm.
- 4.7 mm tube size.
- Clip on retention.

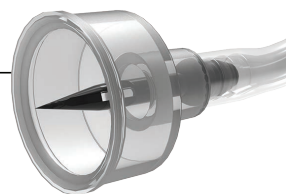

Screw-On 23 Non-Vented Draw-Off

- Size: 23 mm.
- 4.7 mm tube size.
- 20 mm bottle closure.
- 23 mm retention thread.



Screw-On 24 Non-Vented Draw-Off

- Size: 24 mm.
- 4.7 mm tube size.
- 20 mm bottle closure.
- 24 mm retention thread.



Screw-On 27.5 Non-Vented Draw-Off

- Sizes: 27.5 mm.
- 4.7 mm and 6.4 mm tube size.
- 20 mm bottle closure.
- 27 mm retention thread.



Screw-On 29 Non-Vented Draw-Off

- Size: 29 mm.
- 4.7 mm and 6.4 mm tube size.
- 20 mm bottle closure.
- 29 mm retention thread.



Standard Vented Draw-Off

- Sizes: 20 mm, 27-30 mm and 33 mm.
- Short crimp available in 33 mm.
- 4.7 mm tube size.



High Flow Vented Draw-Off

- Sizes: 20 mm, 27-30 mm and 33 mm.
- Short crimp available in 33 mm.
- 6.4 mm tube size.
- Designed to achieve better flow with more viscous formulations.



Long Spike Vented Draw-Off

- Sizes: 20 mm, 27-30 mm and 33 mm.
- Short crimp available in 33 mm.
- 6.4 mm tube size.
- Designed to achieve better flow with more viscous formulations.
- Long Spike ensures vented air is delivered away from the product draw-off zone.

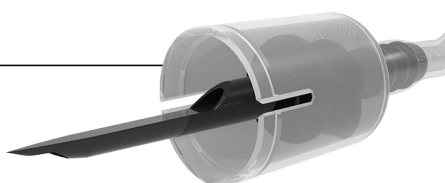



Handiject

- Enables the user to inject livestock more remotely.
- Compatible with most injectors and allows a safe distance between the operator and animal.
- Provides different handle grip to the Flexi Shot (below).



Flexi Shot

- Enables the user to inject livestock more remotely.
- Compatible with most injectors and allows a safe distance between the operator and animal.
- Provides different handle grip to the Handiject (above).



Metricheck™



Metricheck is a tool used to check for endometritis in dairy cows. The cup is inserted into the vagina of the cow where it is drawn back along the floor of the vagina. The cup collects a sample of mucus on its way out. The mucus is then easily checked, visually or biologically, for evidence of infection. Used in this way, infections can be detected and treated promptly to reduce the number of failed inseminations.

- Made from stainless steel.
- Kits come with spare rubber cups.
- Spare rubber cups are available.



Thermal Sleeves

- A strong neoprene sleeve offers both thermal (hot or cold) and physical protection from extreme temperatures.
- A light, effective design, this thermal sleeve is available as an adjustable arm mounting band for quick and easy set up before administration.
- Available to fit 100 mL and 250 mL bottles and pillow packs.



Multi-Shot Implanter

Specifically designed to administer Radio Frequency Identification (RFID) Tags and other small implants from an integrated multi-shot loading cartridge.



Transfer Spike

The Transfer Spike allows an efficient no-spill transfer of dilutant to freeze dried product or mixing of liquids between bung sealed bottles. The unique Clamp design removes the need to support either bottle during the process.

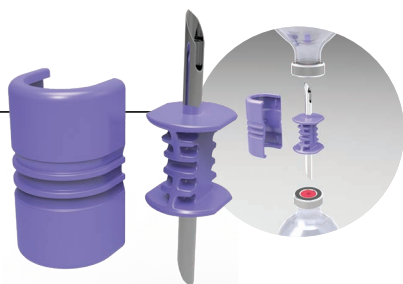

Product Development

Simcro's successful history with pharmaceutical partnerships has enabled collaboration on many highly confidential and market sensitive products. Our ability to operate both professionally and with total confidence can be assured.

Our Research and Development team designs and develops highly customised delivery systems and packaging for the world's leading pharmaceutical companies.

Our industry leading innovation process has been responsible for world leading Intellectual Property and award winning products such as the Optiline™ Drencher and the Simcro Sekurus™ Injector.

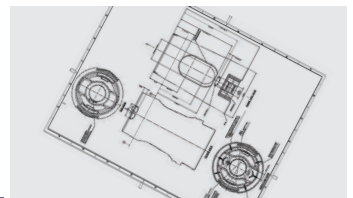
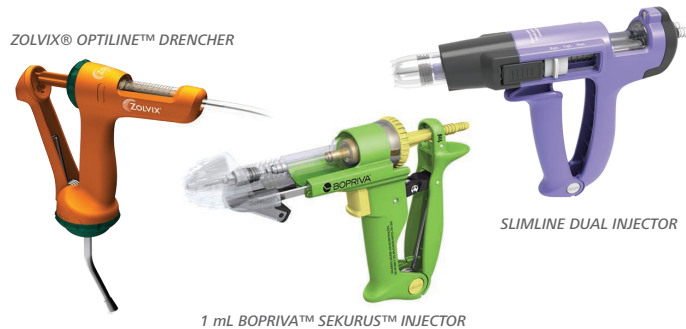

PRODUCT BRIEF

All of our products begin with a brief. It's Simcro's view that we should challenge the brief to extract the widest possible parameters for success.

We will always ensure that the completed brief addresses five fundamental criteria:

- > Animal Welfare.
- > Operator Safety.
- > Treatment Efficacy.
- > User Experience.
- > Commercial Viability.

Frequently our proposed solutions are so innovative we enter into manual confidentiality agreements with the client.

01

IDEATION

The first step in responding to the brief is to link the design brief to known technologies. From this technical base, we investigate more innovative possibilities, balancing them against the commercial requirements for the end product.

02

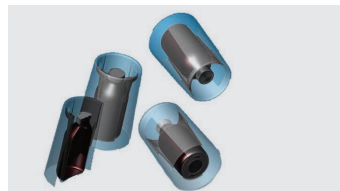

CONCEPT VISUALISATION

Simcro presents an innovation storyboard to it's clients, detailing inspirations and conclusions, before traversing a wide range of options that will fulfil the brief.

Our approach is to include thinking beyond the brief when we feel we can meet criteria in a different way.

03

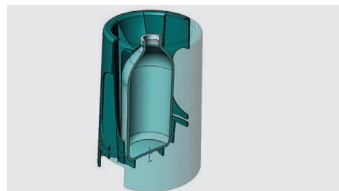

CONCEPT FINALISATION

Our clients select their preferred concepts for further exploration.

Occasionally, the best solution will be a cross pollination of the variety of technologies Simcro has proposed. In this case, we present further concepts that marry the best attributes of our solutions.

04

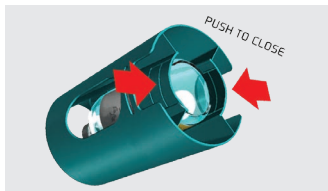

CONCEPT DEVELOPMENT

Concept development is where blue-sky thinking meets commercial reality.

After establishing a commercialisation agreement, Simcro will begin creating a proof of principal prototype. These are machined from 3D CAD models and hand assembled to test ergonomic principles.

05



DESIGN DEVELOPMENT

This stage begins with an iterative design process that fully resolves the product against the client's requirements and the five key criteria listed in the Product Brief.

Each product is fully realised as a 3D CAD model that is manufacturing and assembly ready before being machined as a fully functioning prototype.

06

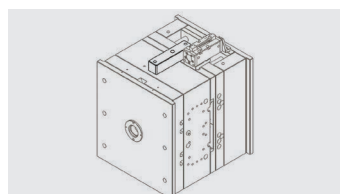

PRODUCT TOOLING

Tooling begins once the prototype has passed field-testing and is signed off by the client.

Simcro then designs, manufactures and commissions the tooling and assembly jigs for commercial production.

07



ALPHA TRIALS

This is the first manufacturing and assembly trial. It is the first time the final product has been produced under commercial conditions, and it is released again for final field assessment.

08



PRODUCT DOCUMENTATION

Once Alpha Trials are passed, Simcro documents all user and maintenance instructions to required international standards.

Internal assembly and quality specifications are established and jigs created to facilitate the assembly process.

09



COMMERCIAL PRODUCTION

The finished product enters production at Simcro's production facility, and is packaged and delivered to client specifications, worldwide.

10





DATAMARS

Simcro Limited

13 Kaimiro Street, Pukete
Hamilton, New Zealand 3200

TEL +64 7 846 7723

EMAIL info@simcro.com

www.simcro.com

www.datamars.com

NJ Phillips Pty Limited

44 Gindurra Road, Somersby
NSW, Australia 2250

TEL +61 243 402 044

EMAIL njp1@njphillips.com.au

www.njphillips.com

www.datamars.com

Brands of Datamars Group

njphillips.com

